

ESCORTED ENTICING DOURO RIVER CRUISE

Oct 25 - Nov 5, 2027

12 Days / 10 Nts

aboard

AMA WATERWAYS®
& Lisbon Pre-Stay

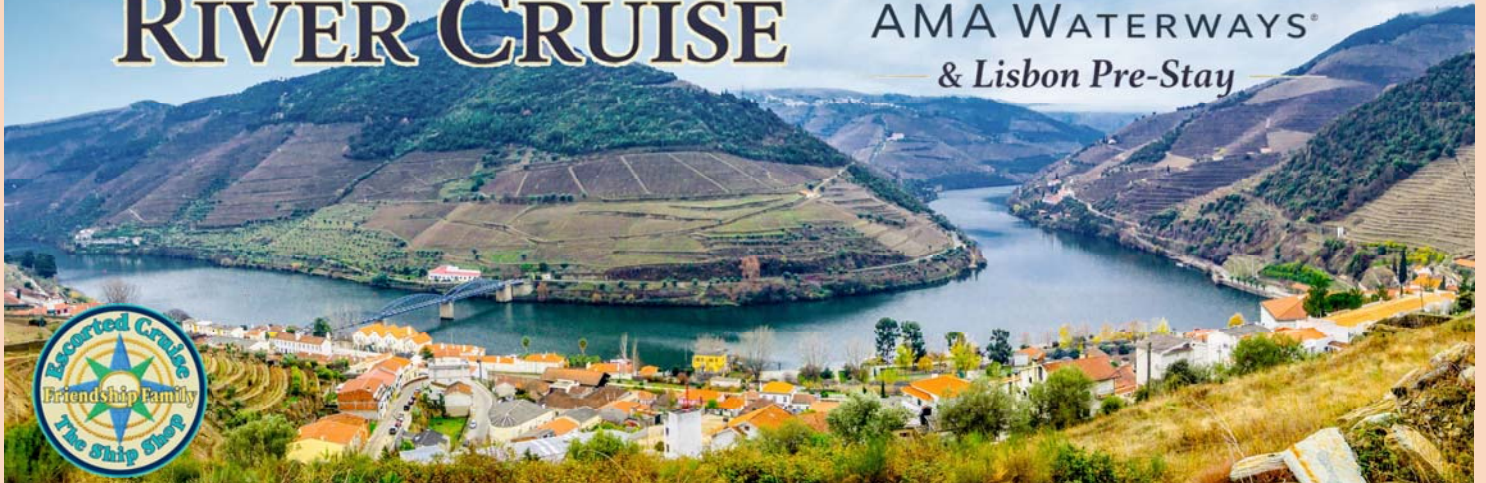

Portugal: 3 Nt Lisbon Stay & 7 Nt Douro River Cruise Come Celebrate Friendship Tours' 50th Anniversary!

Start your journey with three unforgettable nights in **Lisbon**, Portugal's vibrant "City of Seven Hills," where you'll enjoy a guided sightseeing tour plus a full-day excursion to fairytale **Sintra**, featuring a visit to the colorful **Pena Palace**. Then sit back and relax as you embark on a luxurious 7-night **AmaWaterways** cruise roundtrip from **Porto**, sailing the breathtaking **Douro River**. This scenic river winds through Portugal's legendary wine country, past terraced vineyards, charming villages, and dramatic valleys—offering a slower, more intimate way to experience the heart of the region. It's the perfect blend of historic cities, fairy-tale landscapes, and relaxed river cruising.



Included Features:

- Roundtrip Motorcoach to Logan Airport
- Flights to Lisbon and home from Porto, Portugal & All Transfers
- Ship Shop Escort throughout tour
- 3 Nts Lisbon with Sightseeing & Breakfast Daily
- 7 Nt Cruise Roundtrip from Porto aboard the beautiful AMA Sintra:
 - All gourmet meals onboard
 - Free flowing red & white wine from the local region, beer and soft drinks for lunch and dinner
 - Complimentary "Sip & Sail" cocktail hour offering happy hour menu 5 evenings before dinner
 - Captain's Gala Dinner, Theme Dinners
 - Piano music nightly
 - Complimentary coffee, tea, bottled water & iced tea all day Cappuccino, Latte & Espresso during all meals
 - Fitness Center
 - Sun Deck with heated pool and walking track
 - Daily Shore Excursion Program with English Speaking Guides and use of Quietvox headsets
- All Taxes & Port Fees



FRIENDSHIP TOURS
THE SHIP SHOP

705 Bloomfield Ave, Bloomfield, CT 06002
860-243-1630 • 800-243-1630
www.friendshiptours.net

Day 1, Oct 25: Join your Ship Shop Escort for your flights to Lisbon, Portugal

Day 2, Oct 26: LISBON—Arrive in Lisbon and transfer to your hotel. Balance of day to explore Lisbon on your own. Perched on rolling hills along the Tagus River, **Lisbon** charms visitors with colorful tiled buildings, historic neighborhoods, and a relaxed Old World feel.



Day 3, Oct 27: LISBON—One of Europe’s most beautiful cities, Lisbon, stretches across several hills along the Tagus River. On your escorted tour, you’ll see Belém Tower, a fortified 4-story tower made of limestone, and visit the late Gothic Jerónimos Monastery, the burial place of many Portuguese kings and heroes. You will also taste a typical Portuguese pastry, Pastéis de Belém—yum!

Day 4, Oct 28: LISBON—Enjoy a morning excursion to Serra de Sintra, one of the loveliest mountain villages in Portugal and a favorite summer residence of the Portuguese royal family for more than 500 years. Long an inspiration for artists and poets, Lord Byron once called it “perhaps the most delightful village in Europe.” High up on a rocky peak, you will tour Pena Palace, a wonderful fairytale castle dating back to Portugal’s Romantic period.

Day 5, Oct 29: LISBON to PORTO—Ride a motorcoach to Tomar and take in the Castle and Convent of the Order of Christ, a UNESCO World Heritage Site that is a brilliant work of 12th- to 16th-century architecture. Continue on to Porto and board the ship for your *Enticing Douro* cruise. The AMA Sintra will be your home for the next 7 nights while you cruise the beautifully scenic Douro River.



Day 6, Oct 30: REGUA—Visit the Baroque-style Palacio de Mateus and its gardens. Inside the house, you’ll see interesting furnishings, paintings and a ceiling of intricately carved wood. The gardens here are considered some of the most beautiful in Portugal.



Day 7, Oct 31: VEGA DE TERRON, SPAIN—In the morning, spend time soaking up the beauty of this picturesque port before you visit Castelo Rodrigo, a small fortified village perched high on a hilltop with centuries-old walls, steep narrow streets and fantastic views. You can also opt to hike up to the village should you wish a more active exploration.

Day 8, Nov 1: VEGA DE TERRON, SPAIN—SALAMANCA—Drive to Salamanca, a UNESCO World Heritage Site. Built of golden sandstone, Salamanca is known as a “living museum,” and you will have an opportunity to step back in time to the Middle Ages during your guided walking tour, which includes the city’s elegant university buildings, the New Cathedral, the intriguingly decorated House of Shells and Plaza Mayor.

Day 9, Nov 2: PINHAO—Spend time soaking up the beauty of the Douro River as you cruise to Pinhão. Be treated to an exclusive lunch at Quinta da Avesada, where you’ll enjoy an authentic and traditional dining experience complete with entertainment. Quinta da Avesada is also a fascinating interactive museum commemorating the history and culture of wine in the Alto Douro region, so you’ll have fun discovering all the various stages of wine production as well as doing plenty of tasting. Savor the flavors of Portugal’s renowned fortified wine, vinho do porto, made exclusively in the Douro Valley. Head to a local quinta for your authentic Port-wine tasting experience and enjoy the sweet nectar of this fascinating region.

Day 10, Nov 3: REGUA—Travel to picturesque Lamego, home to one of the most important pilgrimage sites in all of Portugal, where you’ll go to the Nossa Senhora dos Remédios (Sanctuary of Our Lady of Remedies). The shrine features a staircase of nearly 700 steps, beautifully decorated with white and blue tiles, which the more active adventurer will want to climb on a guided hike. Concluding both tours, you will have the opportunity to sample local traditional specialties, such as bôlas de Lamego, bread filled with smoked ham; presunto, a type of dry-cured ham; and Espumante, a Portuguese sparkling wine. For lunch, indulge in a traditional Portuguese meal with your fellow travelers in Regua at a local quinta – a country estate – for a truly authentic culinary experience.



Day 11, Nov 4: PORTO—The colorful city of Porto blends the best of old and new, which you can discover on an guided walking tour of the historic quarter, a UNESCO World Heritage Site, including the Cathedral, one of the city’s oldest monuments; and the São Bento Railway Station, known for its blue and white tile panels depicting scenes from Portuguese history. If you prefer to get more active, you can go on a guided hike. In the afternoon, you’ll also enjoy a tasting of Port, Portugal’s most renowned contribution to the world of wine. In the evening, enjoy the illuminated landscapes of Porto on a scenic cruise aboard your ship.

Day 12, Nov 5: PORTO & FLIGHTS HOME—Today we disembark in Porto and transfer to the airport for our flights home taking with us wonderful memories of Portugal. Your motorcoach awaits your arrival to transfer you back to CT.

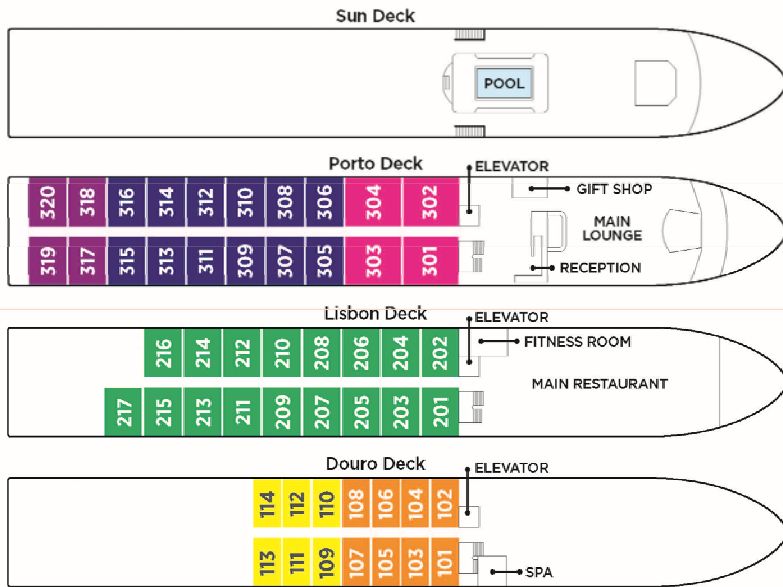

Elevator reaches all three stateroom decks.

AMA Sintra:

Built: 2025
 Length: 260
 Width: 37
 Crew: 38
 Staterooms: 51
 Passengers: 102



Douro River Valley

- Suite** Porto Deck - Outside Balcony - 323 sq. ft.
- Cat. A** Porto Deck - Outside Balcony - 215 sq. ft.
- Cat. B** Lisbon Deck - Outside Balcony - 215 sq.
- Cat. C** Porto Deck - French Balcony - 161 sq. ft.
- Cat. D** Douro Deck - Panoramic Window - 161 sq. ft.
- Cat. E** Douro Deck - Panoramic Window - 161 sq. ft.

Stateroom layouts are not to scale.

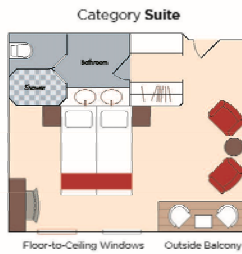

Floor-to-Ceiling Windows Outside Balcony



Outside Balcony Floor-to-Ceiling Windows



French Balcony



Panoramic Window



Costs are Per Person, Twin occupancy including Flights & Lisbon Pre-Stay & 7 nt cruise

Cat E	Panoramic Window	\$7299.pp twin
Cat D	Panoramic Window	\$7499.pp twin
Cat C	French Balcony Cabin	\$8369.pp twin
Cat B	Balcony Cabin	\$8939.pp twin
Cat A	Balcony Cabin	\$9149.pp twin
Suite	Suite Balcony Cabin	\$10229.pp twin

Roundtrip transportation & Escort is based on a minimum # of passengers.

Included Air Cost is based on an estimate for 2027 sailings—cost is subject to change until air is contracted.

Mobility: This tour involves moderate-level walking tours in each port, mostly on uneven surfaces. This cruise may not be suitable for passengers with mobility issues.

Deposit: \$1500.pp due with reservation. 2nd Deposit: \$1500.pp due by Jul 15, 2026. 3rd Deposit: \$1500.pp due by Oct 31, 2026. Space is subject to availability at time of deposit. Check with the Ship Shop at any time for current availability on this sailing.

Final Payment: April 15, 2027

Cancellation Penalty: If cancelled after deposit and before Nov 15, 2026 fee of \$1500.pp; Nov 16, 2026-Apr 15, 2027 fee of \$4500.pp; Apr 16-Jun 15, 2027 fee of 75% of total fare; No refunds after Jun 15, 2027. Air penalties are not included in above and may be additional.

TRIP PROTECTION COVERAGE:

Trip Protection Coverage is strongly recommended. Friendship Tours offers Travel Protection insurance through two providers: NTA Travel Protection Plan and Travel Insured International. Travel Protection offers coverage for Cancellation for Covered Medical Reasons, Trip Interruption, Emergency Medical Services, Travel Delay, & more. Cancel for Any Reason (CFAR) coverage can be purchased from either provider (see timing guidelines below) and will reimburse up to 75% of prepaid nonrefundable trip costs if canceled at least 48 hours prior to your trip for a non-covered reason.

Insurance Premiums are non-refundable. Terms and conditions apply.

NTA (AON) Travel Protection Plan is based on the cost of the trip and offers 3 levels of insurance: Basic, Enhanced, or Enhanced with CFAR. Emergency medical coverage is secondary coverage. The pre-existing medical condition exclusion can be waived by purchasing the Enhanced Plan or the Enhanced with CFAR Plan within 14 days of initial trip payment.

To enroll: <https://nta.aontravelprotect.com> **Tour Operator Location #076068** OR call AON 1-800-388-1470.

Travel Insured International Worldwide Trip Protector (WTP) plans are based on each person's age as well as the cost of the trip and offer several levels of coverage including Platinum and Deluxe. Emergency medical coverage is primary coverage. Policy must be purchased within 14 days (for Deluxe) or 21 days (for Platinum) of your initial payment to have the pre-existing medical condition exclusion waived and to purchase CFAR coverage. Bundles for cruises and flights are also available.

To enroll: <https://www.friendshiptours.net/protection-plan> **Agency #18649**

This package is subject to our full Terms & Conditions including our Tour Policies and Responsibilities which can be found on our website at <https://www.friendshiptours.net/tour-policies>. Paper copies are available upon request. It is your responsibility to read these Terms & Conditions. By signing up and making payment on a tour, you agree to be bound to these Terms & Conditions. Cruise lines reserve the right to alter itineraries including change or cancellation of ports. These changes will not be considered a material change and will not be considered cause for cancellation or refund by the guest.

Proof of Citizenship:

U.S. Citizens: Valid Passport required—must be valid 6 months past the return date

Non U.S. Citizens are responsible for obtaining proper documentation for travel.

Friendship Tours / The Ship Shop is not responsible for passengers not having proper documentation for travel

FOR MORE INFORMATION CONTACT: The Ship Shop 860-243-1630 800-243-1630



FRIENDSHIP TOURS
THE SHIP SHOP
705 Bloomfield Ave, Bloomfield, CT 06002
860-243-1630 • 800-243-1630
www.friendshiptours.net

